

CERNIERE C10 CON SCODELLINO Ø26

HINGES C10 WITH Ø26 CUP

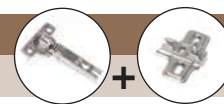
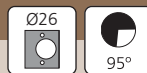

- Chiusura con molla.
- Spessore della porta da 12 a 22 mm.
- Regolabile tridimensionalmente.
- Tolleranza di foratura dello scodellino D = 3 ~ 5 mm.

- Spring closure.
- For 12 ~ 22 mm door thickness.
- Adjustable in 3 dimensions.
- Distance to cup bore edge D = 3 ~ 5 mm.

C10

Collo dritto

Full overlay hinge

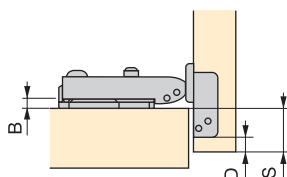

$B = 14 + D - S$

Descrizione Description	Cod.		
Per vite Screw-on	12399	07	500
A pressione Ø8 Knock-in Ø8	12472	07	500
A pressione Ø10 Knock-in Ø10	12402	07	500

Acciaio / Steel

Mezzo collo

Half overlay hinge

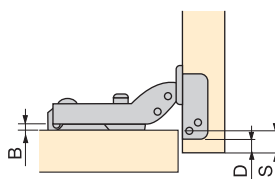

$B = 5 + D - S$

Descrizione Description	Cod.		
Per vite Screw-on	12400	07	500
A pressione Ø10 Knock-in Ø10	12403	07	500

Acciaio / Steel

Collo alto

Insert hinge

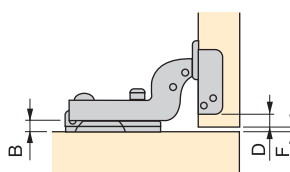

$B = D + F - 2$

Descrizione Description	Cod.		
Per vite Screw-on	12401	07	500
A pressione Ø10 Knock-in Ø10	12404	07	500

Acciaio / Steel



**SISTEMA DI FISSAGGIO DELLO SCODELLINO
CUP PLATE SYSTEM**

Per vite:
Screw-on:

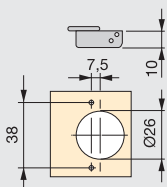

A pressione Ø8:
Knock-in Ø8:

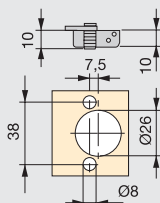

A pressione Ø10:
Knock-in Ø10:

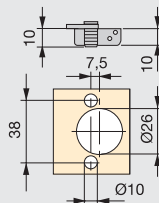

Per il montaggio si raccomanda l'utilizzo di viti TSP Ø4 x 16 Cod. 5032305 o TGS Ø4 x 15 Cod. 5000907 - Ø3,5 x 16 Cod. 5000807.

For the assembly, we recommend to use screws flat head Ø4 x 16 Cod. 5032305 or raised head Ø4 x 15 Cod. 5000907 - Ø3,5 x 16 Cod. 5000807.

BASETTE C10

C10 PLATES



C10

- Regolazione di ± 2 mm.
- Compatibili con distanziali e cunei.

- Adjustable by ± 2 mm.
- Compatible with spacers and wedges.

Basetta per vite

Screw-on plate



Per il montaggio si raccomanda l'utilizzo di viti TSP $\varnothing 4 \times 16$ Cod. 5032305 o TGS $\varnothing 4 \times 15$ Cod. 5000907 - $\varnothing 3,5 \times 16$ Cod. 5000807.

For the assembly, we recommend to use screws flat head $\varnothing 4 \times 16$ Cod. 5032305 or raised head $\varnothing 4 \times 15$ Cod. 5000907 - $\varnothing 3,5 \times 16$ Cod. 5000807.

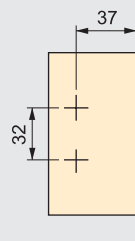

Altezza Height	Cod.		
1,5	12416	07	500
3	12417	07	500

Acciaio / Steel

Basetta a pressione

Knock-in plate

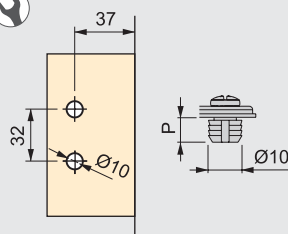

Altezza Height	P	Cod.	
1,5	11	12568	07 500
3	11	12569	07 500

Acciaio / Steel

Basetta montaggio misto

Mixed mounting plate

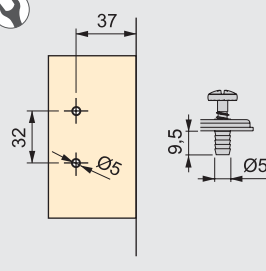

Altezza Height	Cod.		
1,5	10579	07	500
3	10580	07	500

Acciaio / Steel

Basetta Euro

Euro screw plate

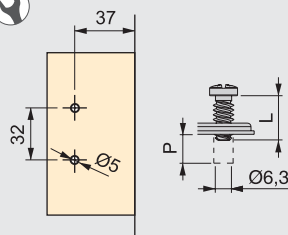

Altezza Height	L	P	Cod.	
1,5	14	12	12576	07 500
1,5	10	8	12420	07 500
3	10	8	12421	07 500

Acciaio / Steel