

CHIUSURE AUTOMATICHE

AUTOMATIC LATCHES

Chiusura Pushmatic per vite

Screw-on Pushmatic

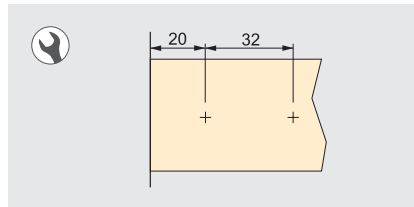
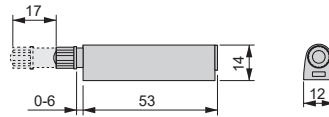

- Il modello magnetico include placca metallica.
- The magnetic model includes the metallic plate.

Tipo di chiusura Latch type	Cod.		
Ammortizzata Bumper	12630	21	200
Magnetica 0,85 kg Magnetic 0,85 kg	12631	21	200

Tecnoplastica / Plastic

Chiusura Pushmatic per vite

Screw-on Pushmatic

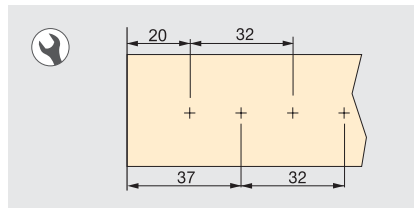
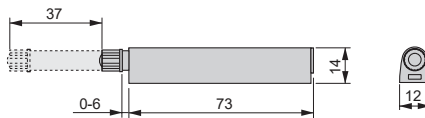

- Il modello magnetico include placca metallica.
- The magnetic model includes the metallic plate.

Tipo di chiusura Latch type	Cod.		
Ammortizzata Bumper	12632	21	200
Magnetica 0,85 kg Magnetic 0,85 kg	12633	21	200

Tecnoplastica / Plastic

Chiusura Push Latch per vite

Screw-on Push Latch

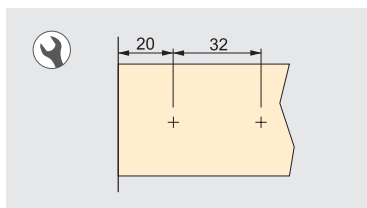
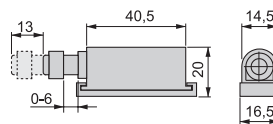
Consultare piastre metalliche
per chiusure magnetiche.Per il montaggio con le viti
si raccomanda viti con testa
pozidrive truciolari di Ø3.See metal plates for magnetic
latches.For screw mounting Ø3
selftapping posidriv screws are
recommended.

Tipo di chiusura Latch type	Cod.		
Ammortizzata Bumper	20329	- 21	100
Magnetica 3,5 kg Magnetic 3,5 kg	20331	17 21	100

Tecnoplastica / Plastic

Chiusura Push Latch per vite

Screw-on Push Latch

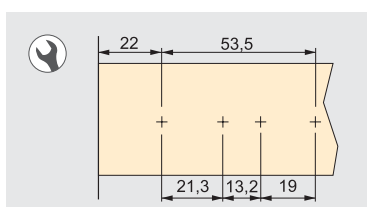
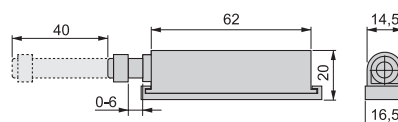
Consultare piastre metalliche
per chiusure magnetiche.Per il montaggio con le viti
si raccomanda viti con testa
pozidrive truciolari di Ø3.See metal plates for magnetic
latches.For screw mounting Ø3
selftapping posidriv screws are
recommended.

Tipo di chiusura Latch type	Cod.		
Ammortizzata Bumper	20338	16 17 21	100
Magnetica 3,5 kg Magnetic 3,5 kg	20339	16 17 21	100

Tecnoplastica / Plastic

16 | Plastica noce
Brown plastic17 | Plastica nera
Black plastic21 | Plastica grigia
Grey plastic

Push Latch regolabile ad incasso

Built-in adjustable Push Latch

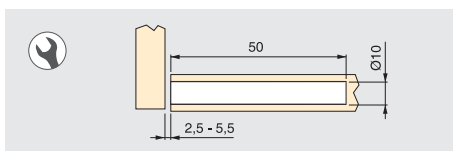
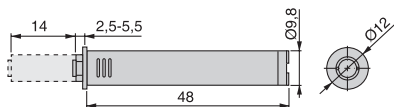

Tipo di chiusura Latch type	Cod.		
Ammortizzata Bumper	20019	21	100
Magnetica 1,7 kg Magnetic 1,7 kg	20020	21	100

Tecnoplastica / Plastic

Consultare piastre metalliche per chiusure magnetiche.

See metal plates for magnetic latches.

Supporto per Push Latch regolabile ad incasso

Support for built-in adjustable Push Latch closing mechanism

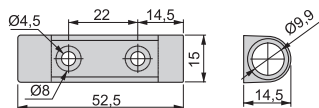

Cod.		
19081	21	100

Tecnoplastica / Plastic

Per il montaggio si raccomanda viti Ø3,5 x 16 Cod. 50314 05.
For the assembly, we recommend to use screws Ø3,5 x 16 Cod. 50314 05.

Push Latch ad incasso

Built-in Push Latch

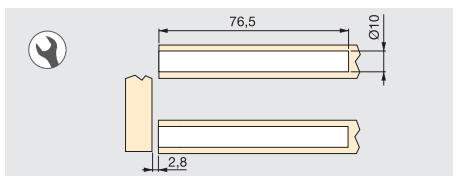
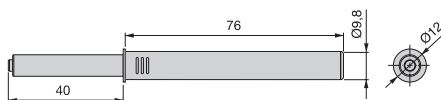

Tipo di chiusura Latch type	Cod.		
Ammortizzata Bumper	20340	21	100
Magnetica 3,5 kg Magnetic 3,5 kg	20341	21	100

Tecnoplastica / Plastic

Consultare piastre metalliche per chiusure magnetiche.

See metal plates for magnetic latches.

Push Latch regolabile ad incasso

Built-in adjustable Push Latch

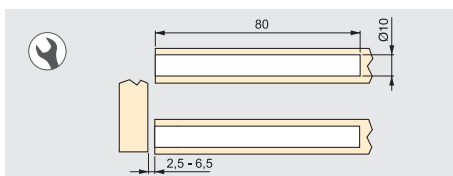
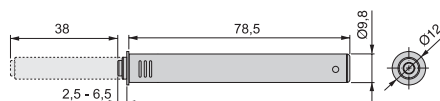

Tipo di chiusura Latch type	Cod.		
Ammortizzata Bumper	19083	21	100
Magnetica 3,5 kg Magnetic 3,5 kg	19084	21	100

Tecnoplastica / Plastic

Consultare piastre metalliche per chiusure magnetiche.

See metal plates for magnetic latches.

Supporto per Push Latch regolabile ad incasso

Support for built-in adjustable Push Latch

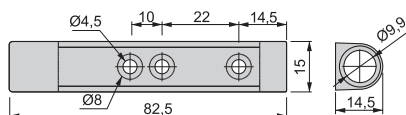

Cod.		
19082	21	100

Tecnoplastica / Plastic

Per il montaggio si raccomanda viti Ø3,5 x 16 Cod. 50314 05.
For the assembly, we recommend to use screws Ø3,5 x 16 Cod. 50314 05.

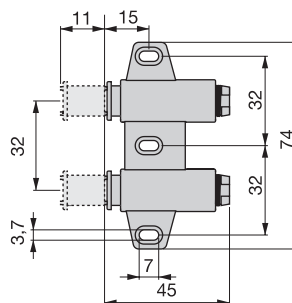
Doppia chiusura magnetica "push"*Twin magnetic latch*

Forza Force	Cod.		
3 kg	20293	17 21	100

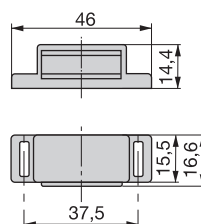
Acciaio e tecnoplastica
Steel and plastic**CHIUSURE MAGNETICHE E PIASTRE***MAGNETIC LATCHES AND PLATES***Magnetica***Surface-mounted*

Forza Force	Cod.		
3,2 kg	20305	15 16	100

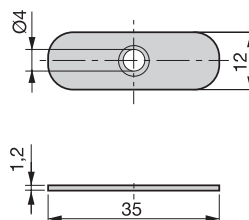
Acciaio e tecnoplastica
Steel and plastic**Piastra retta per magnete***Rectangular plate for magnetic latches*

Cod.		
20309	05	100

Acciaio / Steel

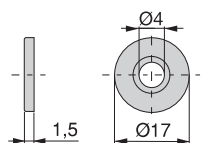
Piastra tonda per vite per magnete*Plate without pin for magnetic latches*

Cod.		
90050	05	500

Acciaio / Steel

