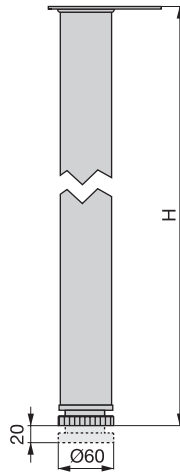
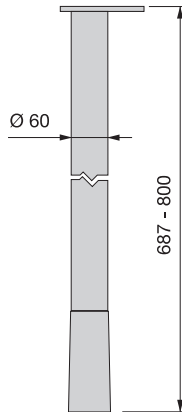

**GAMBE 60****60 LEGS****Gamba 60***60 leg*

| H   | Cod.  | 11 | 12 | 14 | 25 | 51 |   |
|-----|-------|----|----|----|----|----|---|
| 710 | 30536 | 11 | 12 | 14 | 25 | 51 | 4 |
| 738 | 30477 | -  | -  | -  | 25 | -  | 1 |
| 830 | 30439 | 11 | -  | -  | 25 | 51 | 4 |
| 870 | 30480 | 11 | -  | 14 | 25 | 51 | 1 |

Acciaio / Steel

- Include viti Ø5x25 per il fissaggio della base al piano.
- Includes Ø5x25 screws to fix the base to the board.

**Gamba Conus 60***Conus 60 leg*

Cod.

30689 25 1

Acciaio e tecnoplastica  
Steel and plastic

- Include viti Ø5x25 per il fissaggio della base al piano.
- L'anello centrale permette di bloccare la regolazione per ottenere un maggiore fissaggio della gamba.
- Includes Ø5x25 screws to fix the base to the board.
- Central bolt enables the regulator to be blocked to achieve better fixing of the leg.

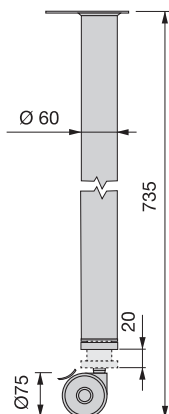
**Gamba 60 con ruota e freno***Leg 60 with castor and brake*

Cod.

30616 25 1

Acciaio / Steel

- Include viti Ø5x25 per il fissaggio della base al piano.
- Includes Ø5x25 screws to fix the base to the board.



## GAMBE 80

80 LEGS

### Gamba 80

80 leg

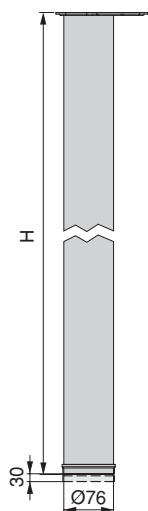

| H     | Cod.  |    |    |    |   |
|-------|-------|----|----|----|---|
| 710   | 30481 | 11 | 25 | 51 | 1 |
| 870   | 30482 | 11 | 25 | 51 | 1 |
| 1.100 | 30483 | 11 | 25 | 51 | 1 |

Acciaio / Steel



- Include viti Ø5x25 per il fissaggio della base al piano.
- Includes Ø5x25 screws to fix the base to the board.

### Gamba in alluminio 80

Aluminium leg 80

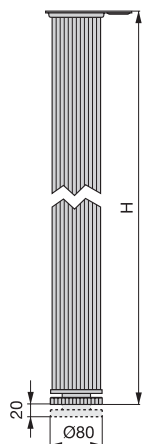

| H   | Cod.  |    |  |   |
|-----|-------|----|--|---|
| 710 | 31124 | 62 |  | 1 |
| 830 | 31125 | 62 |  | 1 |
| 870 | 31217 | 62 |  | 1 |

Alluminio / Aluminium

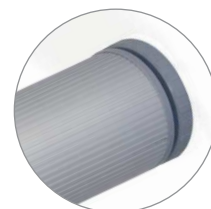

- Include viti Ø5x25 per il fissaggio della base al piano.
- Includes Ø5x25 screws to fix the base to the board.



FORUM TECNICO  
 TECHNICAL FORUM

[www.emuca.com](http://www.emuca.com)

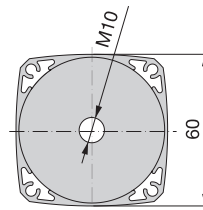
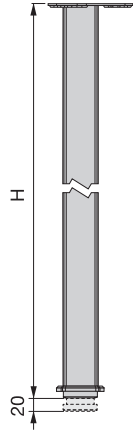
**GAMBE FITWID***FITWID LEGS***Quadrata***Square*

- Include viti Ø5x25 per il fissaggio della base al piano.
- Includes Ø5x25 screws to fix the base to the board.

| H   | Cod.         |           |   |
|-----|--------------|-----------|---|
| 710 | <b>32456</b> | <b>62</b> | 1 |
| 738 | <b>32457</b> | <b>62</b> | 1 |
| 830 | <b>32458</b> | <b>62</b> | 1 |

Alluminio / Aluminium

**BASE PER CRISTALLO***BASE FOR GLASS*

- Per tavoli con gambe da 60, si incolla la base al cristallo, poi si avvita la gamba alla base.
- Per tavoli con gambe da 80, si incolla la base al cristallo, poi si unisce la gamba alla base con la barra filettata 3181803.
- Si raccomanda di utilizzare l'adesivo Vitralit 6128.

- For table with 60 legs, the base must be glued to the glass and once in place the leg can be screwed on to the base.
- For tables with 80 legs, the base must be glued to the glass and once in place the base can be attached using stud code 3181803.
- Vitralit 6128 adhesive is recommended.

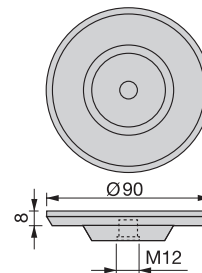
**Base Ice per gambe 60, 80 e Fitwid***Ice base for 60, 80 and Fitwid legs*

Cod.

**31817** **61** **4**

Alluminio / Aluminium

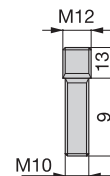
**Barra filettata Ice per gambe 80 e Fitwid***Ice stud for 80 and Fitwid legs*

Cod.

**31818** **03** **4**

Acciaio / Steel

## GAMBE PER TAVOLO

### TABLE LEGS

#### Hera

Hera

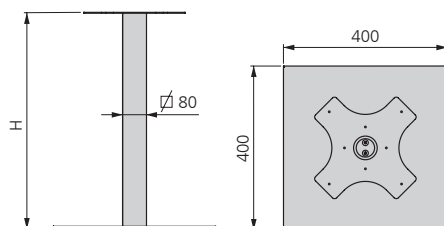

| HERA             | H     | Cod.         |           |   |
|------------------|-------|--------------|-----------|---|
| Base / Base      | -     | <b>32410</b> | <b>62</b> | 1 |
| Colonna / Column | 725   | <b>32412</b> | <b>62</b> | 1 |
| Colonna / Column | 1.090 | <b>32413</b> | <b>62</b> | 1 |

Acciaio e alluminio / Steel and aluminium

- Include feltro per l'appoggio al suolo e viti per il montaggio del piano.
- Per piani massimo 900 x 900 mm.
- Includes felts to protect the flooring and screws for mounting the top board.
- For tops 900 x 900 mm maximum.

#### Duplo

Duplo

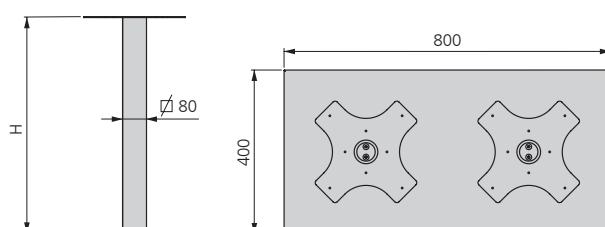

| DUPLO            | H     | Cod.         |           |   |
|------------------|-------|--------------|-----------|---|
| Base / Base      | -     | <b>32411</b> | <b>62</b> | 1 |
| Colonna / Column | 725   | <b>32412</b> | <b>62</b> | 1 |
| Colonna / Column | 1.090 | <b>32413</b> | <b>62</b> | 1 |

Acciaio e alluminio / Steel and aluminium

- Include feltro per l'appoggio al suolo e viti per il montaggio del piano.
- Per piani massimo 1.500 x 900 mm.
- Includes felts to protect the flooring and screws for mounting the top board.
- For tops 1.500 x 900 mm maximum.

